

# FOR SALE



## Great Westbank Warehouse



1155 Destrehan Ave.  
Harvey, LA

- ◆ Warehouse Area: 6,000 Sq. Ft.
- ◆ Office Area: 760 Sq. Ft.
- ◆ Land Area: 1.8 acres
- ◆ Land Dimension: 250' x 324'
- ◆ 250' bulkhead with ramp
- ◆ 1 mile to Mississippi River
- ◆ Zoned M-3

*This office/warehouse property offers a large fenced storage yard, with 250' frontage on the Harvey Canal. The yard is well filled and compacted and offers easy access to the Westbank Expressway and Lapalco Blvd. The waterfront has a heavy duty bulkhead and ramp. Destrehan Ave. is being upgraded to be a major Westbank north/south corridor.*

*For further information please contact:*

Jim Barse, CCIM, SIOR  
(504) 340-9339  
jbarse@latterblum.com

**NAI** LATTER & BLUM  
INC/REALTORS®  
COMMERCIAL REAL ESTATE SERVICES, WORLDWIDE.

800 Common Street Suite 1000 New Orleans, Louisiana 70112 - 2338

[www.latterblum.com](http://www.latterblum.com)

Lat: 29.8896 Lon: -90.0774 Zoom: 0.4 mi Logos are for identification purposes only and may be trademarks of their respective companies.



This map was produced using data from private and government sources deemed to be reliable. The information herein is provided without representation or warranty.

# 1155 Destrehan Ave.

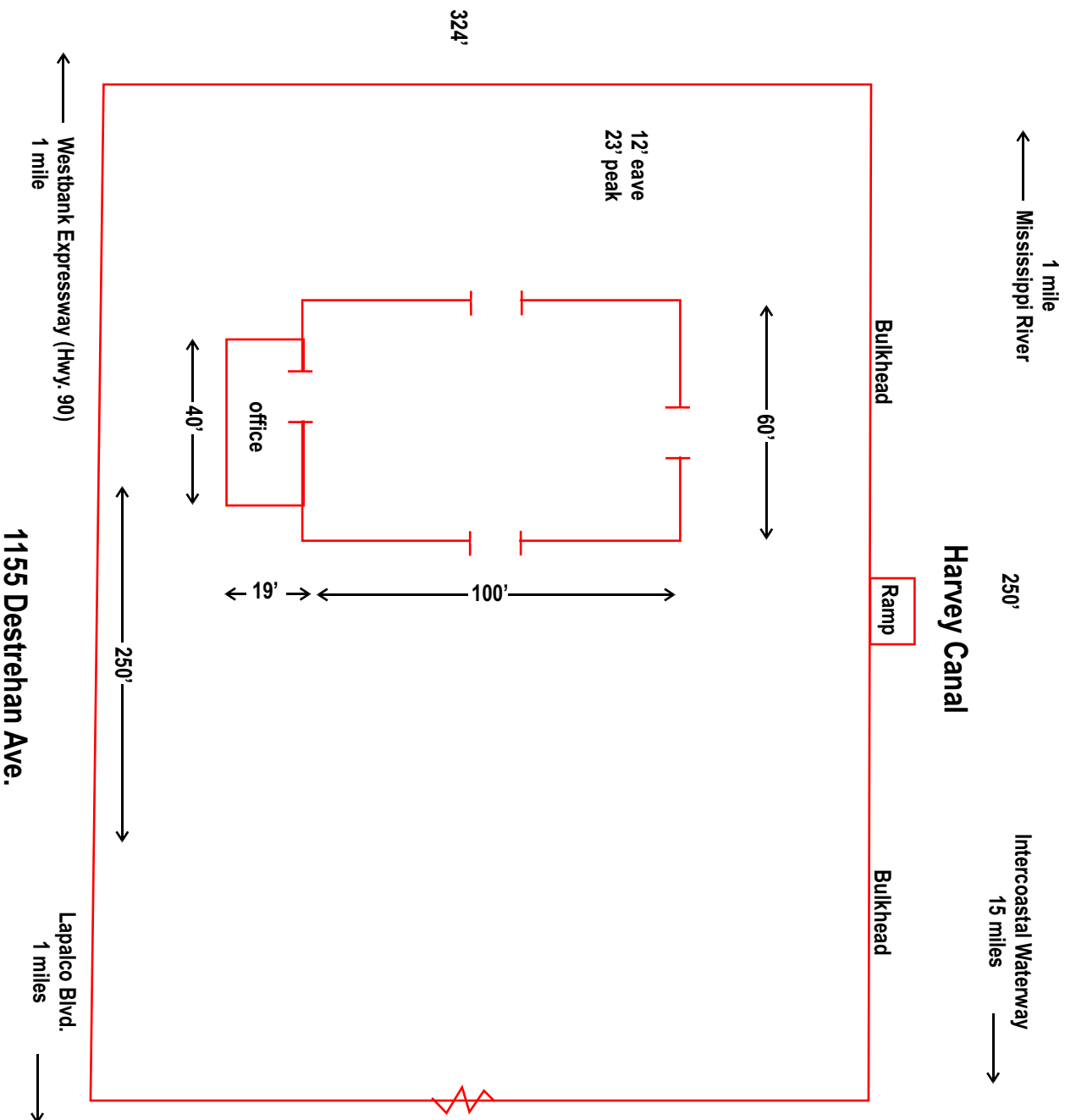

w/h: 60' x 100' = 6,000  
office: 40' x 19' = 760  
6,760

Zoned M-3